

Solar Keymark certified  
 No need magnesium anode and maintenance free  
 Unpressurized tank, pressurized water  
 Hidden tank behind panels  
 5 years warranty

**TSM**

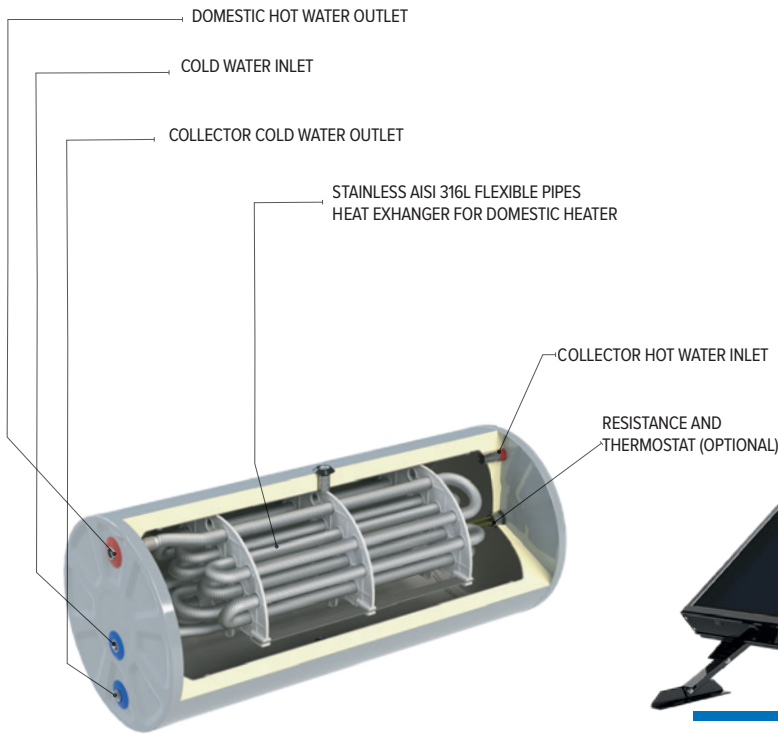

Certification No: 116 BN / 0

## TECHNICAL SPECIFICATIONS

	TSM 120	TSM 150	TSM 200	TSM 300
<b>Product Code</b>	ST-0031	ST-0013	ST-0016	ST-0018
Capacity (lt/day)	120	150	200	300
Tank Working Pressure (bar)	0-3	0-3	0-3	0-3
Heat Exchanger Working Pressure (bar)	2-5	2-5	2-5	2-5
Maximum Temperature (°C)	95	95	95	95
Insulation	50 mm/ 40 kg/m <sup>3</sup> / Polyurethane Insulation (CFC Free)	50 mm/ 40 kg/m <sup>3</sup> / Polyurethane Insulation (CFC Free)	50 mm/ 40 kg / m <sup>3</sup> / Polyurethane Insulation (CFC Free)	50 mm/ 40 kg / m <sup>3</sup> / Polyurethane Insulation (CFC Free)
Heat Exchanger	AISI 316 L Stainless Steel	AISI316 L Stainless Steel	AISI316 L Stainless Steel	AISI 316 L Stainless Steel
Boiler Final Dimensions (Length/ Diameter) (mm)	1000 / 540	1115 / 540	1200 / 540	1725 / 540
Outer Cylinder Materials	Electrostatic Powder Painted ST 37 Steel	Electrostatic Powder Painted ST 37 Steel	Electrostatic Powder Painted ST 37 Steel	Electrostatic Powder Painted ST 37 Steel
Outer Sheet	Painted Galvanized Steel Sheet	Painted Galvanized Steel Sheet	Painted Galvanized Steel Sheet	Painted Galvanized Steel Sheet
Boiler Net Weight (kg)	45	45	65	82
	<b>Wunder ALS 1809</b>	<b>Wunder ALS 2110</b>	<b>Wunder ALS 2512</b>	<b>Wunder ALS 2110* (2 pcs)</b>
<b>DIMENSIONS (mm)</b>	1927x927x90	1988x1041x90	1988x1218x90	1988x1041x90
<b>WEIGHT (kg)</b>	34	37,2	44	37,2
<b>GROSS AREA (m<sup>2</sup>)</b>	1,79	2,07	2,42	2,07
<b>APERTURE AREA (m<sup>2</sup>)</b>	1,62	1,92	2,24	1,92
<b>ABSORBER AREA (m<sup>2</sup>)</b>	1,59	1,89	2,23	1,89
<b>ABSORBER MATERIAL</b>	Almeco-Tinox Highly Selective Aluminium	Almeco-Tinox Highly Selective Aluminium	Almeco-Tinox Highly Selective Aluminium	Almeco-Tinox Highly Selective Aluminium
<b>ABSORPTANCE /EMITTANCE</b>	0,95 / 0,04	0,95 / 0,04	0,95 / 0,04	0,95 / 0,04
<b>WELDING METHOD</b>	LaserWelding	Laser Welding	Laser Welding	Laser Welding
<b>GLASS MATERIAL</b>	Low Iron Tempered Glass	Low Iron Tempered Glass	Low Iron Tempered Glass	Low Iron Tempered Glass
<b>INSULATION MATERIAL</b>	Rock Wool	Rock Wool	Rock Wool	Rock Wool
<b>BASE SHEETING</b>	Embossed- Finished Aluminium Sheet & Carbon Fibre (Equivalent)	Embossed- Finished Aluminium Sheet & Carbon Fibre (Equivalent)	Embossed- Finished Aluminium Sheet & Carbon Fibre (Equivalent)	Embossed- Finished Aluminium Sheet & Carbon Fibre (Equivalent)